

TERMINUS

Carlo Bimbi

Frame: multi-ply plywood inner frame w/non deformable polyurethane foam covered w/polyester padding

Fire retardant foam meets California Bulletin 117A

Legs: steel in Segis powder coat finishes

Back Panels: choice of short or tall back panels which are ordered separately; see page 80

A DETAILED LAYOUT MUST ACCOMPANY ALL TERMINUS ORDERS



	com	1	2	3	4	5	6	7	8	9	10	wt	
I189 STRAIGHT MODULE 31.5w, 25.5d, 31h, 18.5sh	2	1,400	1,500	1,580	1,660	1,740	1,820	1,900	1,980	2,060	2,140	2,220	53
					02 chrome add			181					
I181 STRAIGHT MODULE 47.25w, 25.5d, 31h, 18.5sh	2.5	1,568	1,693	1,793	1,893	1,993	2,093	2,193	2,293	2,393	2,493	2,593	64
					02 chrome add			181					
I182 STRAIGHT MODULE 59w, 25.5d, 31h, 18.5sh	3	1,924	2,074	2,194	2,314	2,434	2,554	2,674	2,794	2,914	3,034	3,154	74
					02 chrome add			181					
I183 STRAIGHT MODULE 71w, 25.5d, 31h, 18.5sh	3.5	2,285	2,460	2,600	2,740	2,880	3,020	3,160	3,300	3,440	3,580	3,720	86
					02 chrome add			181					
I180 CORNER MODULE 43.3w, 43.3d, 31h, 18.5sh	3.5	2,402	2,577	2,717	2,857	2,997	3,137	3,277	3,417	3,557	3,697	3,837	104
					02 chrome add			181					
I187-DX RIGHT CORNER MODULE I184-SX LEFT CORNER MODULE 43.3w, 27.5d, 31h, 18.5sh	2.75	2,108	2,246	2,356	2,466	2,576	2,686	2,796	2,906	3,016	3,126	3,236	128
					02 chrome add			181					
I188-DX RIGHT CORNER MODULE I185-SX LEFT CORNER MODULE 59w, 27.5d, 31h, 18.5sh	3.5	2,484	2,659	2,799	2,939	3,079	3,219	3,359	3,499	3,639	3,779	3,919	122
					02 chrome add			181					

TERMINUS INFO

DX RIGHT CORNER: when seated the longer side of the bench will extend to the right

SX LEFT CORNER: when seated the longer side of the bench will extend to the left

CORNER MODULE: 43.3x43.3 w/25.5d seat



Legs

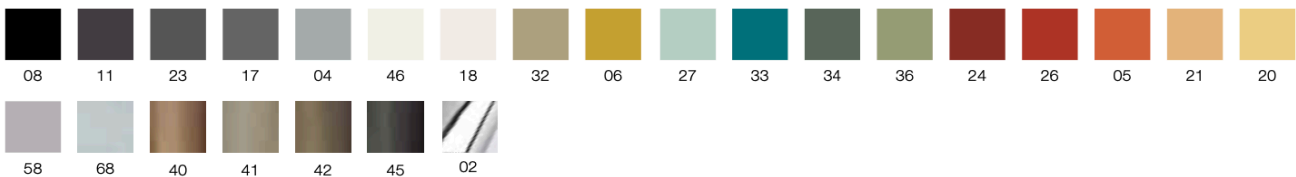

TERMINUS BACK PANELS

Back Panels: bench modules are designed without backs. Exposed backs will require either an upholstered seat back panel, an upholstered high back partition panel, or a laminate high back partition panel

A DETAILED LAYOUT MUST ACCOMPANY ALL TERMINUS ORDERS

	yds	com	1	2	3	4	5	6	7	8	9	10	wt
UPHOLSTERED SEAT BACK PANEL 21"H													
C184-R BACK 28.25"	1	349	399	439	479	519	559	599	639	679	719	759	
C186-R BACK 31.5"	1	349	399	439	479	519	559	599	639	679	719	759	
C185-R BACK 43.3"	1.5	443	518	578	638	698	758	818	878	938	998	1,058	
C181-R BACK 47.25"	1.5	443	518	578	638	698	758	818	878	938	998	1,058	
C182-R BACK 59"	1.75	443	531	601	671	741	811	881	951	1,021	1,091	1,161	
C183-R BACK 71"	2.25	443	556	646	736	826	916	1,006	1,096	1,186	1,276	1,366	
UPHOLSTERED HIGH BACK PARTITION PANEL 39"H (49.25" H FROM FLOOR)													
C284-R BACK 28.25"	1.75	407	495	565	635	705	775	845	915	985	1,055	1,125	
C286-R BACK 31.5"	1.75	501	589	659	729	799	869	939	1,009	1,079	1,149	1,219	
C285-R BACK 43.3"	2.5	501	626	726	826	926	1,026	1,126	1,226	1,326	1,426	1,526	
C281-R BACK 47.25"	2.75	536	674	784	894	1,004	1,114	1,224	1,334	1,444	1,554	1,664	
C282-R BACK 59"	3.5	536	711	851	991	1,131	1,271	1,411	1,551	1,691	1,831	1,971	
C283-R BACK 71"	4.25	536	749	919	1,089	1,259	1,429	1,599	1,769	1,939	2,109	2,279	
LAMINATE HIGH BACK PARTITION PANEL 39"H (49.25"H from floor) in white BI, natural oak RO, wenge WE													
C284-L PANEL 28.25"		438											
C286-L PANEL 31.5"		454											
C285-L PANEL 43.3"		494											
C281-L PANEL 47.25"		513											
C282-L PANEL 59"		562											
C283-L PANEL 71"		590											
TERMINUS INFO													
			MGAN18022 lateral ganging device				71						
			C180FISSAGGIO back to back ganging device for backless benches						246				
			C180FISSAGGIO and C180FISSAGGIO2 back to back ganging devices for compositions with high back partition panels									358	
			M180PIASTR2 metal plate to connect linear high back panels						24				
			M180PIASTR1 metal plate to connect corner high back panels						38				

TERMINUS

Modules



Compositions

A drawing of the required configuration must accompany your order

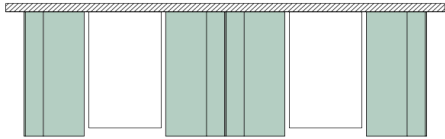

1

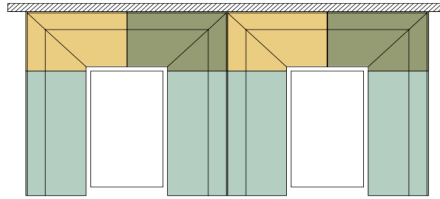

2

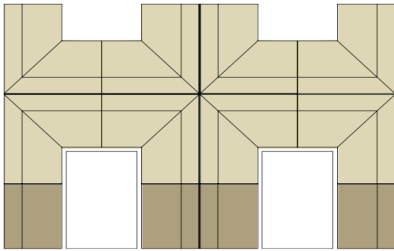

3

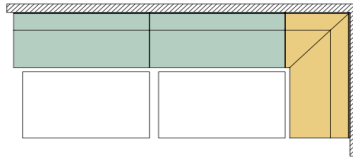

4

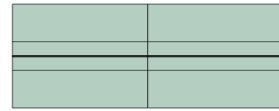

5